

# ADIRONDACK SHOP

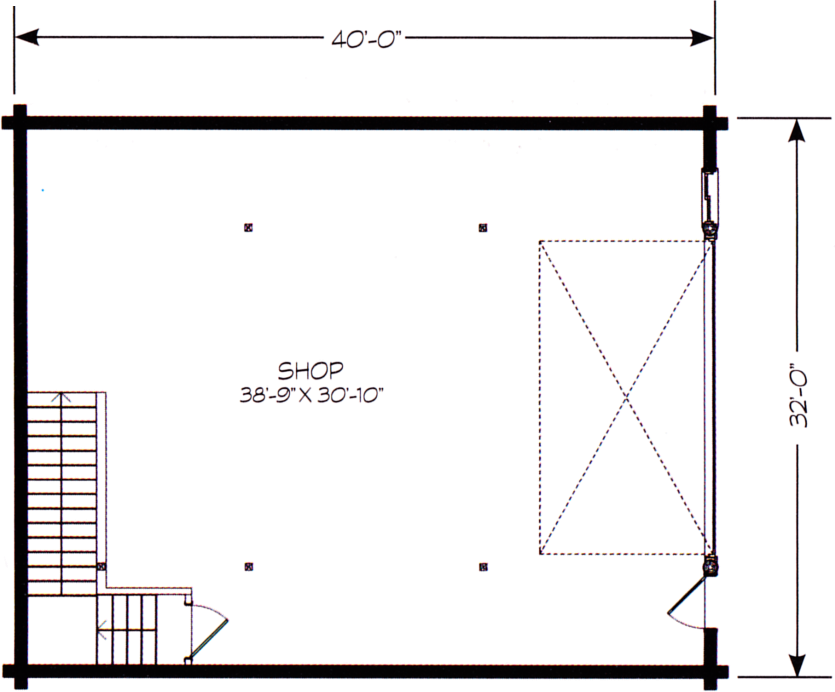

© Yellowstone Log Homes LLC

## MAIN LEVEL



|             |          |
|-------------|----------|
| MAIN LEVEL  | 1,280 SF |
| UPPER LEVEL | 722 SF   |
| TOTAL AREA  | 2,002 SF |

## UPPER LEVEL

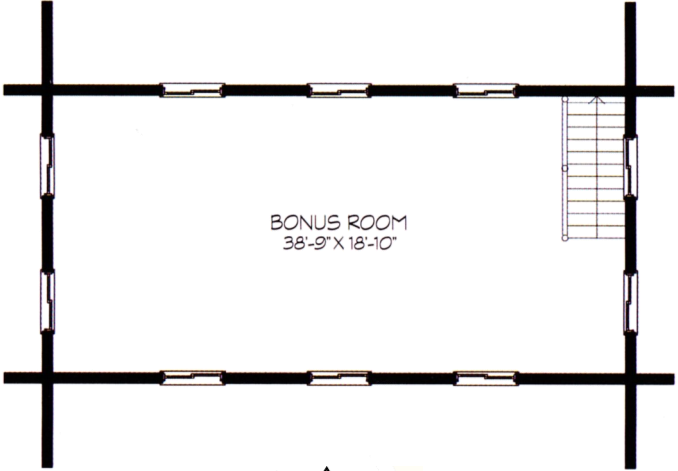

**UTE COUNTRY HOMES, LLC**  
 P.O. BOX 757  
 PAGOSA SPRINGS, CO 81147  
**970-731-3555**  
 WWW.UTECOUNTRYHOMES.COM



The ADIRONDACK SHOP Premium Package with 8" Swedish Cope Cabin Appearance Logs

\$35,723.00 *(shipping & taxes not included)*

*Additional log profiles available, please call for quote*

**PREMIUM PACKAGE INCLUDES** (if shown on prints)

|                              |  |
|------------------------------|--|
| Construction Guide           | Log loft floor joists                          |
| All log walls shown on print | Log stair set                                  |
| Log home screws              | Log porch posts                                |
| Exterior log home stain      | Log railing                                    |
| Foam gasket                  | 2 x 6 T&G <i>(for loft floor decking)</i>      |
| Log home caulking            | 1 x 6 T&G <i>(below roof over living area)</i> |
| Log roof beams               | TP <sup>®</sup> graded beams & wall logs       |
| Log support posts            | Log porch header                               |

**ELITE DRY-IN PACKAGE INCLUDES**

*(Please call for complete package list and current prices 970-731-3555)*

|   |   |
|---|---|
| Metal drip ledge for eave & gable           | Douglas fir 2X framing for exterior decks                                   |
| 1X cedar two step fascia                    | Sub floor adhesive  |
| OSB rim board for eaves                     | 4' x 8' sheets of ¾" T&G OSB  |
| Architectural shingles                      | Wooden I-Joists & LVL's for subfloor  |
| Wooden I-Joists & LVL's for roof rafters    | 2 X pressure treat for sill plate   |
| Roofing felt / ice & water shield           | Sill sealer   |
| 4' x 8' sheets of OSB                       | OSB rim board for subfloor  |
| Blocking between wooden I-Joist             | 4' x 8' sheets of T1-11 subfloor fascia                                     |
| 2X framing for interior walls               | ⅝" couplers and allthread   |
| Double 2 x 6 for window bucking             | Vinyl windows <i>(or upgrade to wood windows)</i>                           |
| Metal drip ledge for subfloor               | Exterior doors  |
| Redwood decking <i>(or upgrade to trex)</i> | Conventional frame stair material<br><i>(if not drawn as log stair set)</i> |