

SUMMIT

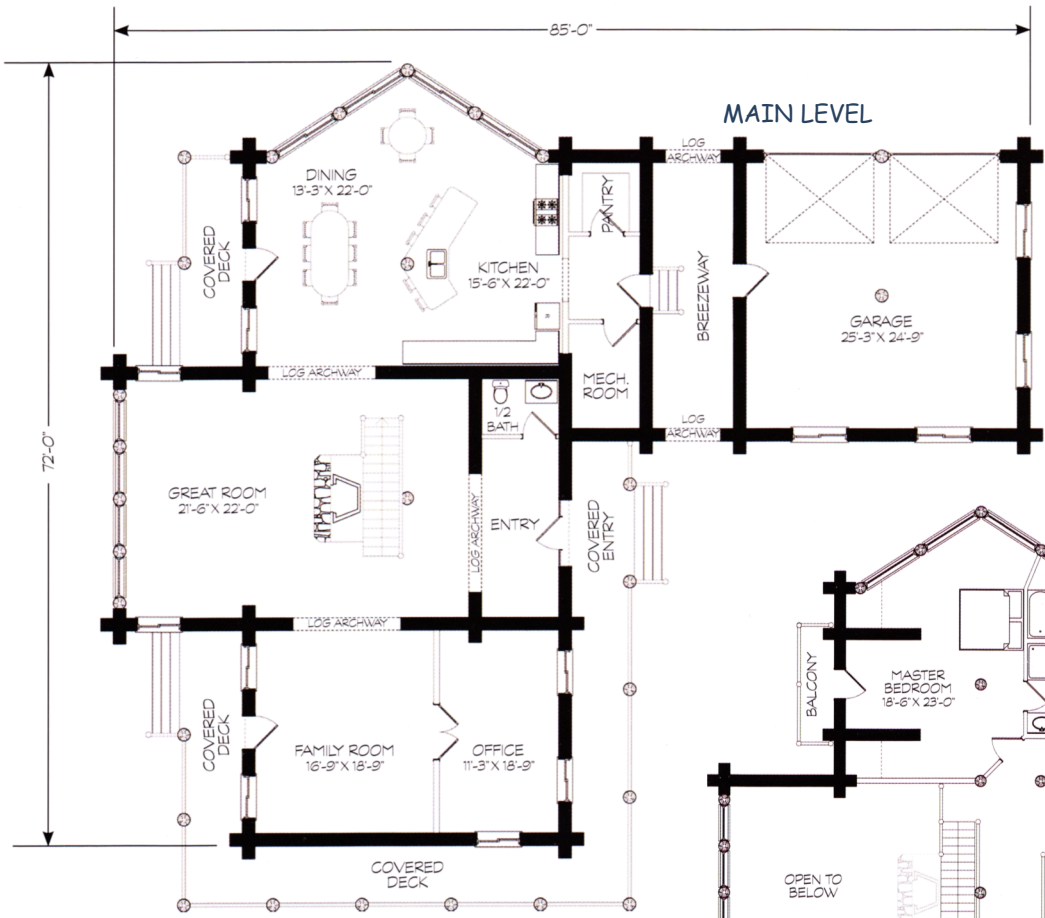

© Yellowstone Log Homes LLC



| | |
|-------------|----------|
| MAIN LEVEL | 2,527 SF |
| UPPER LEVEL | 2,611 SF |
| LIVING AREA | 5,138 SF |
| GARAGE | 720 SF |
| TOTAL AREA | 5,858 SF |

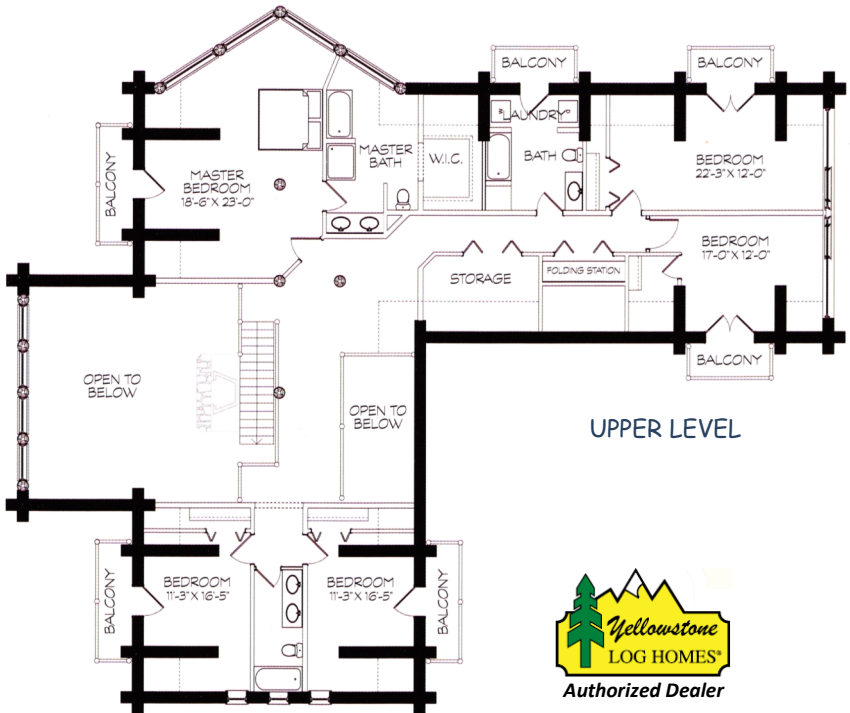

UTE COUNTRY HOMES, LLC

P.O. BOX 757

PAGOSA SPRINGS, CO 81147

970-731-3555

WWW.UTECOUNTRYHOMES.COM



The SUMMIT Premium Package with 8" Swedish Cope Cabin Appearance Logs

\$134,347.00 *(shipping & taxes not included)*

Additional log profiles available, please call for quote

PREMIUM PACKAGE INCLUDES (if shown on prints)

| | |
|------------------------------|--|
| Construction Guide | Log loft floor joists |
| All log walls shown on print | Log stair set |
| Log home screws | Log porch posts |
| Exterior log home stain | Log railing |
| Foam gasket | 2 x 6 T&G <i>(for loft floor decking)</i> |
| Log home caulking | 1 x 6 T&G <i>(below roof over living area)</i> |
| Log roof beams | TP [®] graded beams & wall logs |
| Log support posts | Log porch header |

ELITE DRY-IN PACKAGE INCLUDES

(Please call for complete package list and current prices 970-731-3555)

| | |
|--|--|
| Metal drip ledge for eave & gable | Douglas fir 2X framing for exterior decks |
| 1X cedar two step fascia | Sub floor adhesive |
| OSB rim board for eaves | 4' x 8' sheets of ¾" T&G OSB |
| Architectural shingles | Wooden I-Joists & LVL's for subfloor |
| Wooden I-Joists & LVL's for roof rafters | 2 X pressure treat for sill plate |
| Roofing felt / ice & water shield | Sill sealer |
| 4' x 8' sheets of OSB | OSB rim board for subfloor |
| Blocking between wooden I-Joist | 4' x 8' sheets of T1-11 subfloor fascia |
| 2X framing for interior walls | ⅝" couplers and allthread |
| Double 2 x 6 for window bucking | Vinyl windows (or upgrade to wood windows) |
| Metal drip ledge for subfloor | Exterior doors |
| Redwood decking (or upgrade to trex) | Conventional frame stair material (if not drawn as log stair set) |